



# **DATABASE PLATFORM FOR DIGITAL BUSINESS**

---

- Gaby Schilder | 14-06-2017

Face2Face

# Agenda

- Origins of Postgres and EDB
- EDB Postgres Advanced Server
- The Uniface<sup>®</sup> case
- Oracle compatibility
- Polyglot platform
- Multiple answers
- Cost containment
- Discussion and Questions

# Origins of EDB and Postgres

# Postgres: A Proven Track Record

- Most mature open source DBMS technology
- Enterprise-class features (built like Oracle, DB2, SQL Server)
- Strong, independent community driving rapid innovation

PostgreSQL



Fully ACID Compliant  
MVCC

Point in Time Recovery (PITR)

Data and Index Partitioning

Bitmap Indexes

ANSI Constraints

Triggers & Stored Functions

Views & Data Types

Nested Transactions

Online Backup

Online Reorganization

Foreign Keys

Streaming Replication

Multi-Core Support

JSON Support

HStore

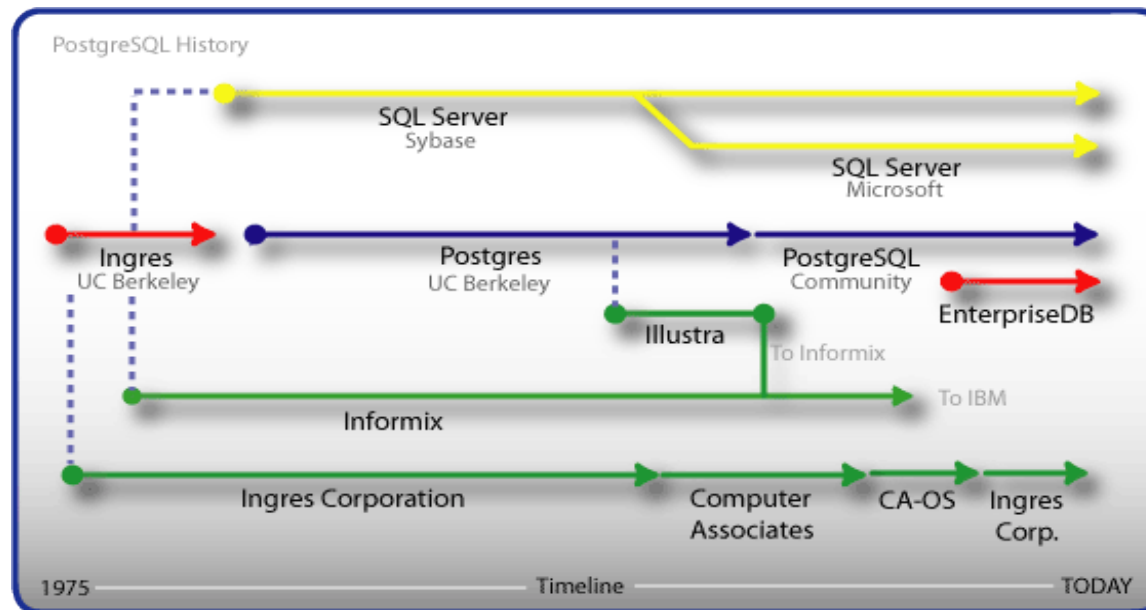

# Postgres' Growth

- Postgres is widely recognized for its long history of proven success and future promise

“We congratulate MongoDB, PostgreSQL and Cassandra for their extraordinary achievements in 2013....The fact that we have three open source tools and two NoSQL systems amongst the winners may be an indication of what 2014 has in store for us.”

## DB-Engines Ranking

The DB-Engines Ranking ranks database management systems according to their popularity. The ranking is updated monthly.

Read more about the [method](#) of calculating the scores.

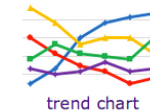

216 systems in ranking, March 2014

Rank	Last Month	DBMS	Database Model	Score	Changes
1.	1.	Oracle <a href="#">@</a>	Relational DBMS	1491.80	-8.43
2.	2.	MySQL <a href="#">@</a>	Relational DBMS	1290.21	+1.83
3.	3.	Microsoft SQL Server <a href="#">@</a>	Relational DBMS	1205.28	-8.99
4.	4.	PostgreSQL <a href="#">@</a>	Relational DBMS	235.06	+4.61
5.	5.	MongoDB <a href="#">@</a>	Document store	199.99	+4.81
6.	6.	DB2 <a href="#">@</a>	Relational DBMS	187.32	-1.14
7.	7.	Microsoft Access <a href="#">@</a>	Relational DBMS	146.48	-6.40
8.	8.	SQLite <a href="#">@</a>	Relational DBMS	92.98	-0.03
9.	9.	Sybase ASE <a href="#">@</a>	Relational DBMS	81.55	-6.33
10.	10.	Cassandra <a href="#">@</a>	Wide column store	78.09	-2.23

**WIRED** GEAR SCIENCE ENTERTAINMENT BUSINESS SECUR

ENTERPRISE | software | database software

### Meet the Open Source Trio Primed to Topple Oracle

BY KLINT FINLEY 01.07.14 9:00 AM

**POSTGRES**  
innovation

**ENTERPRISE**  
reliability

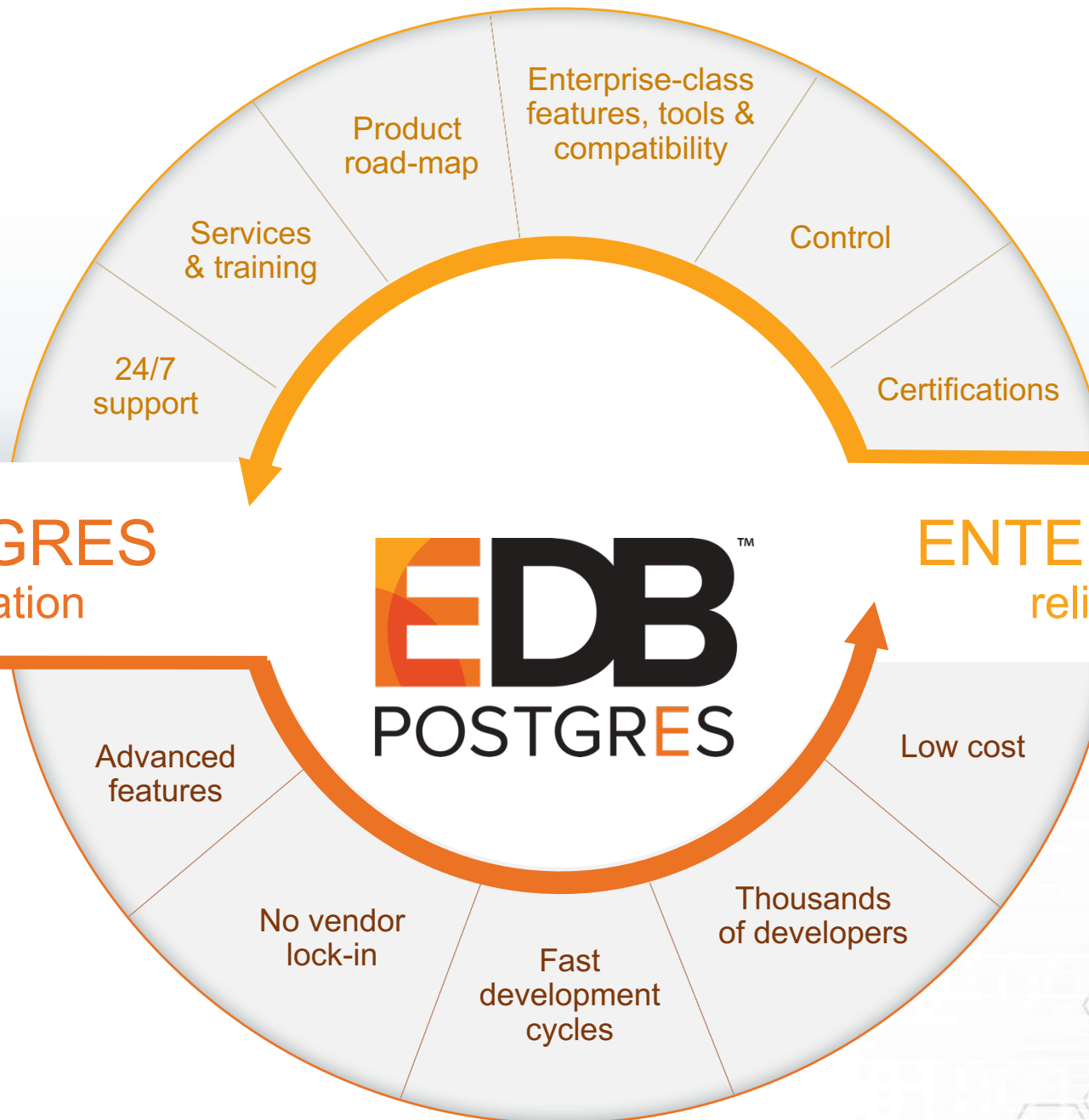

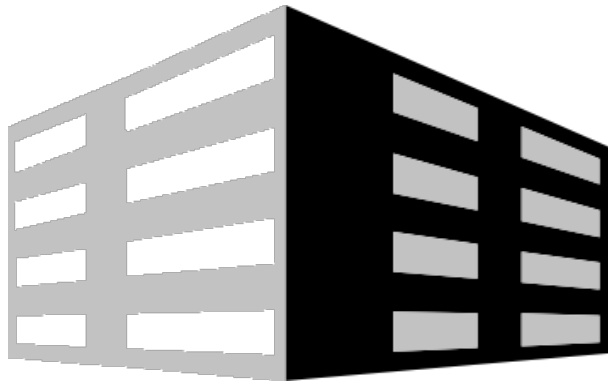

Founded in 2004

- The world leader in open-source based Postgres software and services.
- Customer base > 3700
- 300+ employees
- Offices worldwide
- Recognized RDBMS leader
  - Gartner and Forrester
- Recognized PostgreSQL community leader



# Gartner MQ: EDB is The Leading OSS-Based DBMS



The Gartner report, *Magic Quadrant for Operational Database Management Systems*, by Nick Heudecker, Donald Feinberg, Merv Adrian, Terilyn Palanca, Rick Greenwald was published October 5, 2016.

This graphic was published by Gartner, Inc. as part of a larger research document and should be evaluated in the context of the entire document. The Gartner document is available upon request from EnterpriseDB.

Gartner does not endorse any vendor, product or service depicted in its research publications, and does not advise technology users to select only those vendors with the highest ratings or other designation. Gartner research Publications consist of the opinions of Gartner's research Organization and should not be construed as statements of fact. Gartner disclaims all warranties, expressed or implied, with respect to this research, including any warranties of Merchantability or fitness for a particular purpose.

Figure 1. Magic Quadrant for Operational Database Management Systems



Source: Gartner (October 2016)

# EDB Customers

EDB currently has over 3,700 total customers including 85 of the Fortune 500 and 169 of the Forbes Global 2000



# Sample Customer Performance Stats

- **Global mobile ad network**
  - Largest database is 14TB
  - 1.2 billion transactions a day, 55K transaction per second
  - 400 concurrent users
  - Analyzes 240TB of data per day
- **Online Brokerage Firm**
  - 1 billion writes a day
  - 3,000 transactions per second
  - 800 concurrent users
- **Global stock trade underwriter**
  - Largest database is 8 TB
  - 6 to 10 million transactions per day
- **Global consumer financial services provider**
  - Example application database is 2 TB
  - 200K SELECT statements per second
  - 25K WRITE transactions per second

# Key Partnerships

- **Target Market:** Enterprises, Governments, Cloud/IaaS/PaaS, ISV/OEMs
- **Vertical Focus:** Financial Services; Insurance; Information Technology; Government; Telecommunication

IHV & Appliances	ISV/OEM	SI	Cloud	Eco-System	Channel
       	      	     	   	   	    

# Gartner Application Landscape & Open Source

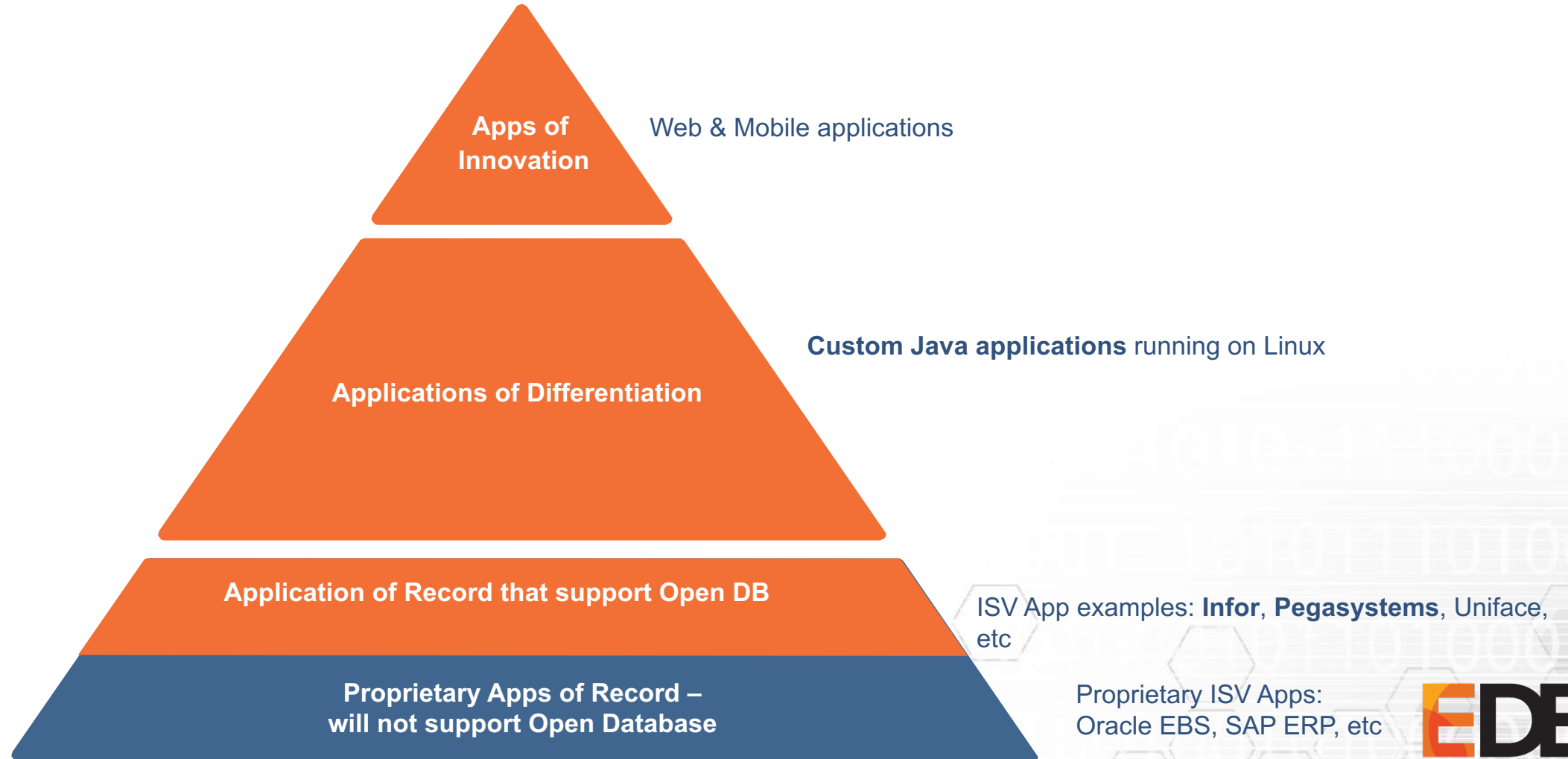

Uniface®  
**IS** compatible!

# Oracle vs. EdDB TCO Comparison on X86

	Oracle Enterprise Edition	EDB Postgres Advanced Server
License Fee Per Core	(8 cores) (x86 processor)	(8 cores) (x86 processor)
Database	\$47,500	included in subscription
Partitioning	\$11,500	Included
Data Guard	\$11,500	Included
Diagnostics	\$5,000	Included
Total License Fee per Core	\$75,500	included in subscription
Total License Fee per Server (CapEx) (0.5 core factor)	<b>\$302,000</b>	<b>\$0</b>
Annual support/subscription cost per core	22% of License Fee	\$1,750 per core
Annual Support/Maintenance per Server (OpEx)	<b>\$66,440</b>	<b>\$14,000</b>
<b>Total 3 Year License and Support Cost</b>	<b>\$501,320</b>	<b>\$42,000</b>

No CAPEX • Annual OPEX reduction **79%** • 3 YR TCO cost savings **92%**



# Database Platform For Digital Business

## Edb Postgres And EDB Ark

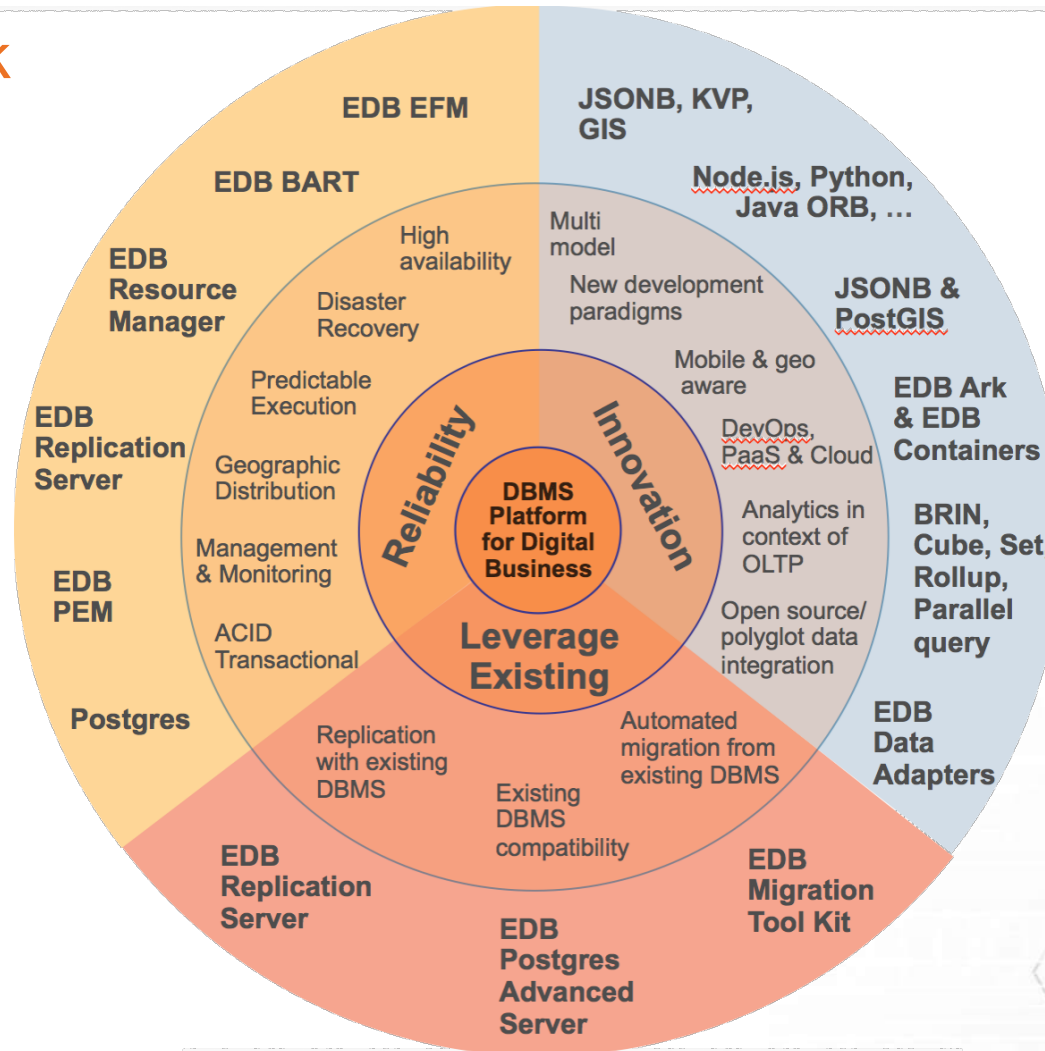

# Data Management Landscape

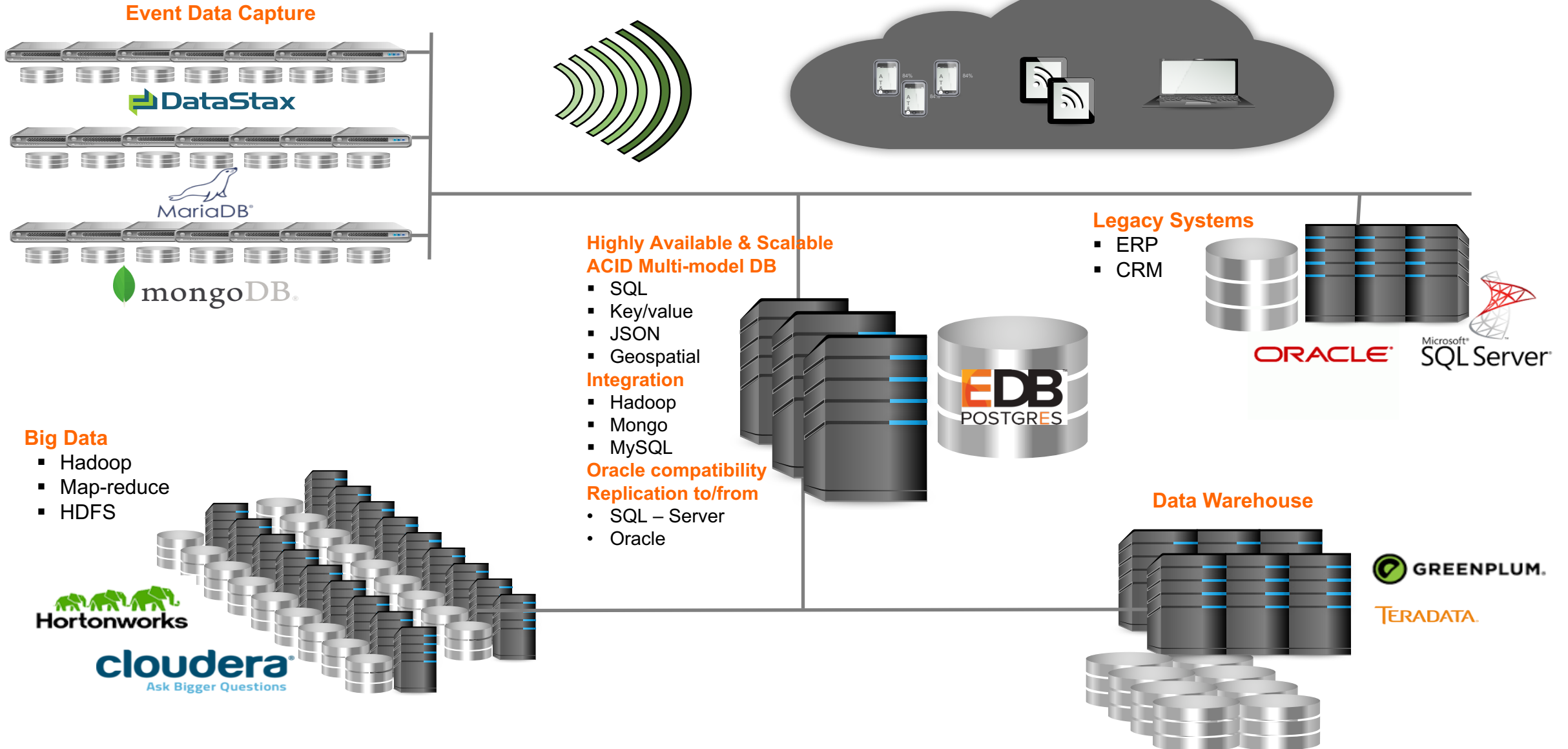

# EDB Postgres Platform 2017

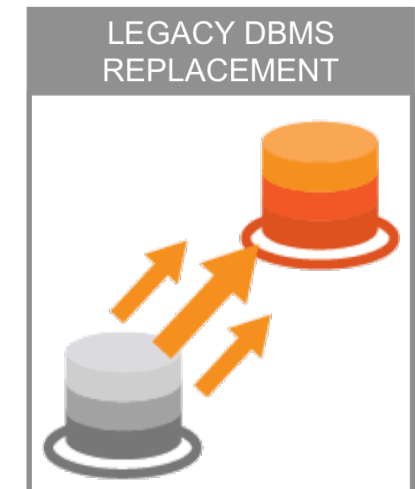
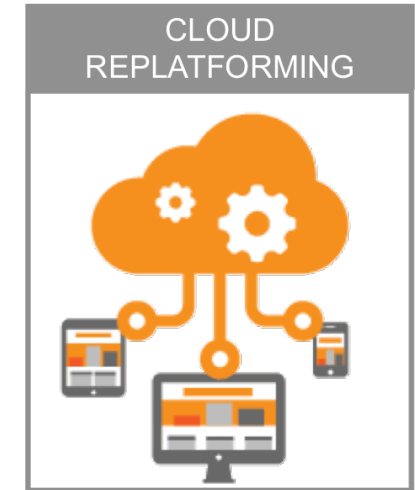
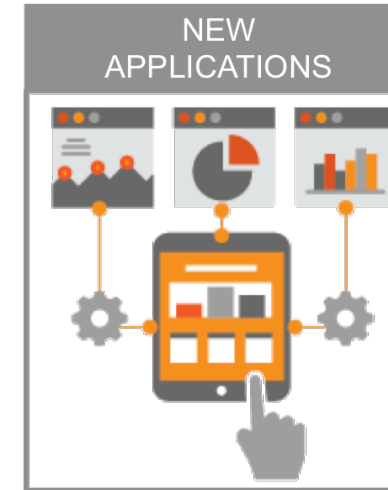
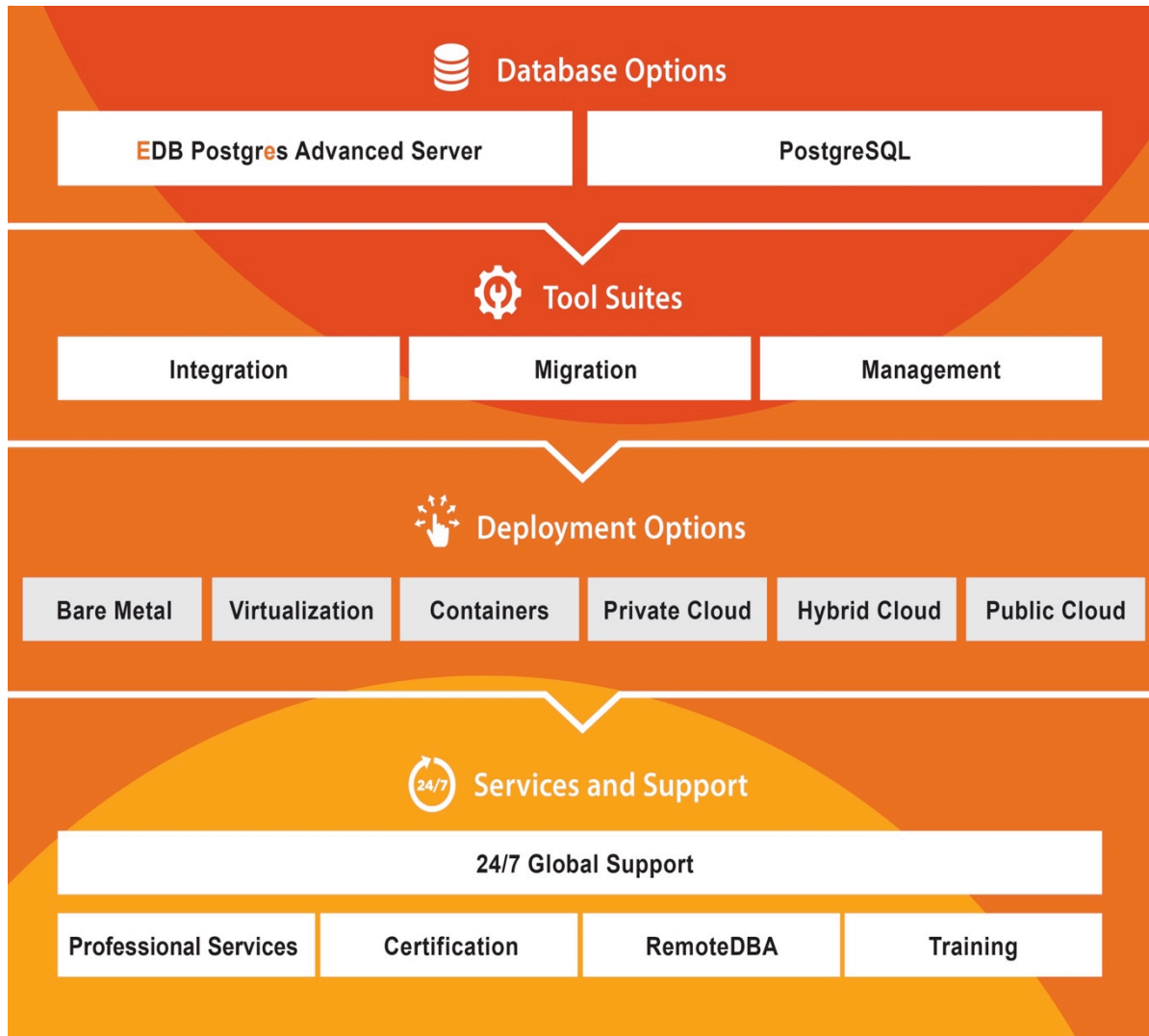

# EDB Postgres Platform

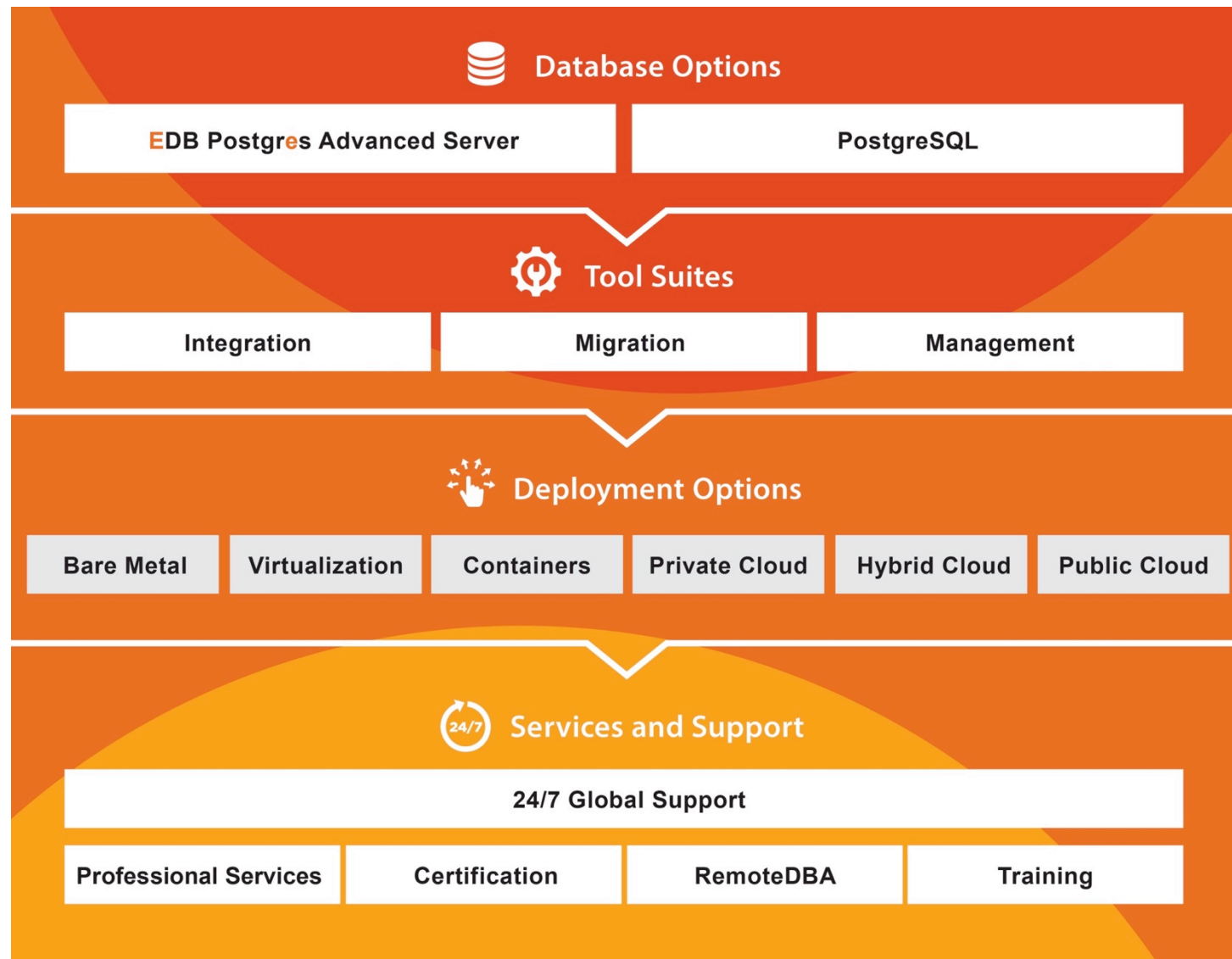

# EDB Postgres Platform – DBMS Options

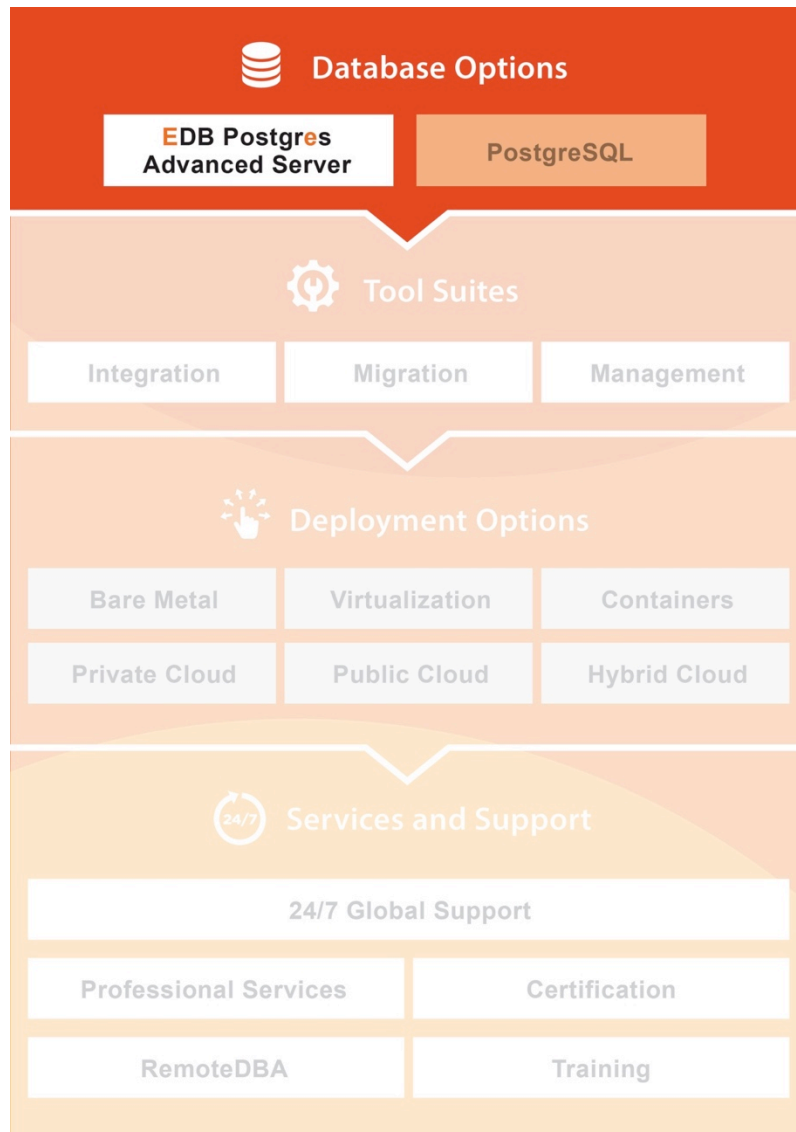

## EDB Postgres Advanced Server

- Based on open-source PostgreSQL
- Adds performance, security, and database compatibility for Oracle
- Includes additional developer and DBA features
- EDB Postgres Enterprise: 24x7 support plus management, integration and migration tool suites deployable across many traditional platforms as well as cloud platforms

# EDB Postgres Platform – DBMS Options

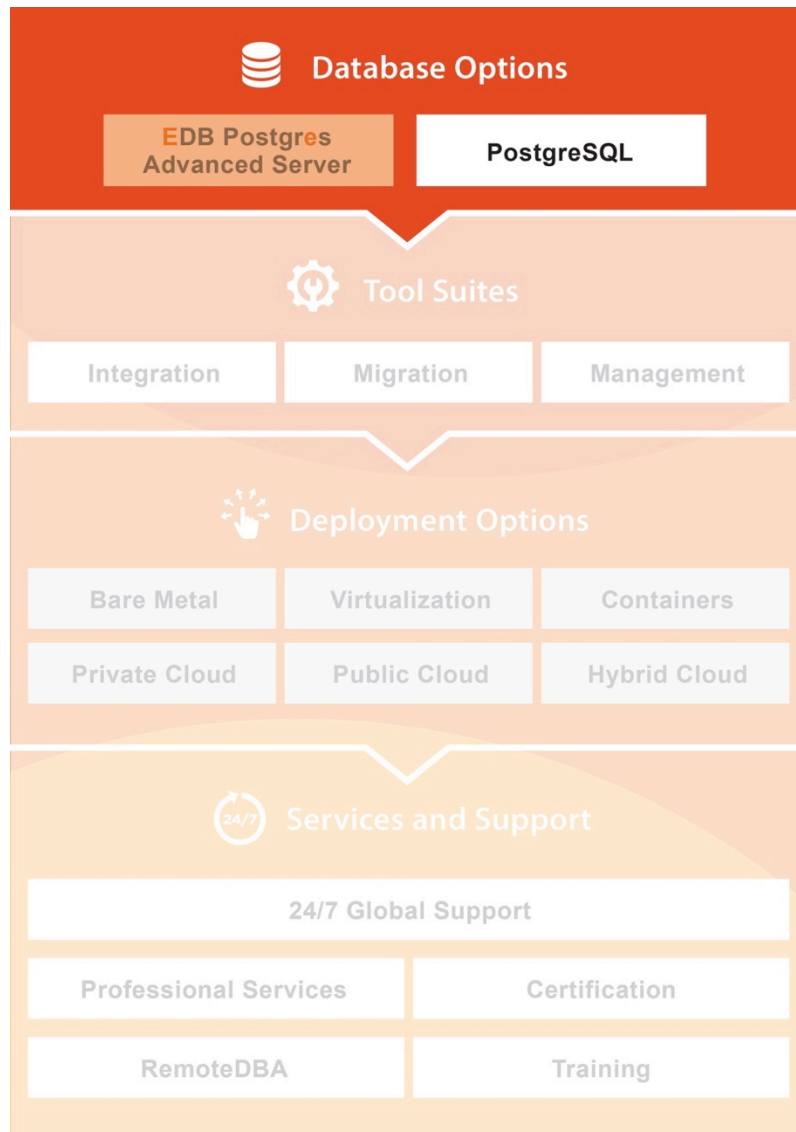

## PostgreSQL

- The world's most advanced open source database
- EDB Postgres Standard: 24x7 support plus management, integration and migration tool suites deployable across many traditional platforms as well as cloud platforms

# The EDB Postgres Platform - Subscriptions



Capabilities	Components	Subscriptions			Benefits
<b>Database</b>	EDB Postgres...	<b>Enterprise</b>	<b>Standard</b>	<b>Developer</b>	
Open source-based DB w. enterprise features (Oracle compatibility, performance & security)	Advanced Server	X		X	ACID compliant, reliable, high performance and extensible relational data store
Open source DB	PostgreSQL		X	X	
<b>Management Suite</b>					
GUI-based Management, Monitoring and Alerting	Enterprise Manager	X	X	X	Comprehensive management, monitoring, alerting and tuning with advanced backup/recovery operations and configurable database high availability;
Backup and Recovery	Backup and Recovery	X	X	X	
High Availability	Failover Manager	X	X	X	
<b>Integration Suite</b>					
Data Replication (SMR/MMR)	Replication Server (SQL Server, Oracle, Postgres)	X	X	X	Data Federation and Distributed Transaction Management capability to integrate the database with the enterprise data management environment. * Beta
Data Integration	Data Adapters (FDW)	X	X	X	
Distributed Transaction Management	XA Connector*	X		X	
<b>Migration Suite</b>					
Database Migration	Migration Toolkit (Oracle, Sybase, MS SQL)	X	X	X	Tools to migrate applications from commercial databases to open source-based databases
Database Migration Assessment Tool	Migration Assessment (Oracle)	X	X	X	DMA Tool is available as part of a services engagement
<b>24 x 7 Global Support</b>					
<b>Professional Services, RemoteDBA, Training, Certification</b>					
<b>Deployment Options: Bare Metal, Virtual, Public, Private &amp; Hybrid Clouds</b>					

# EDB Postgres Platform

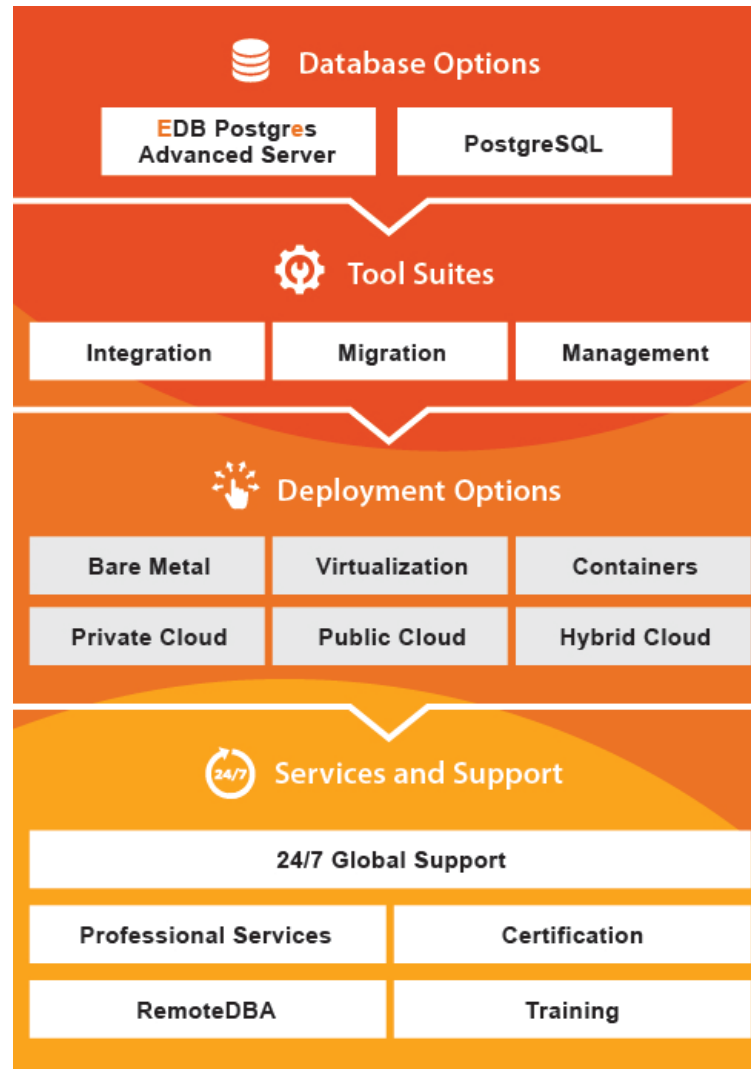

# EDB Postgres Platform – Services & Support

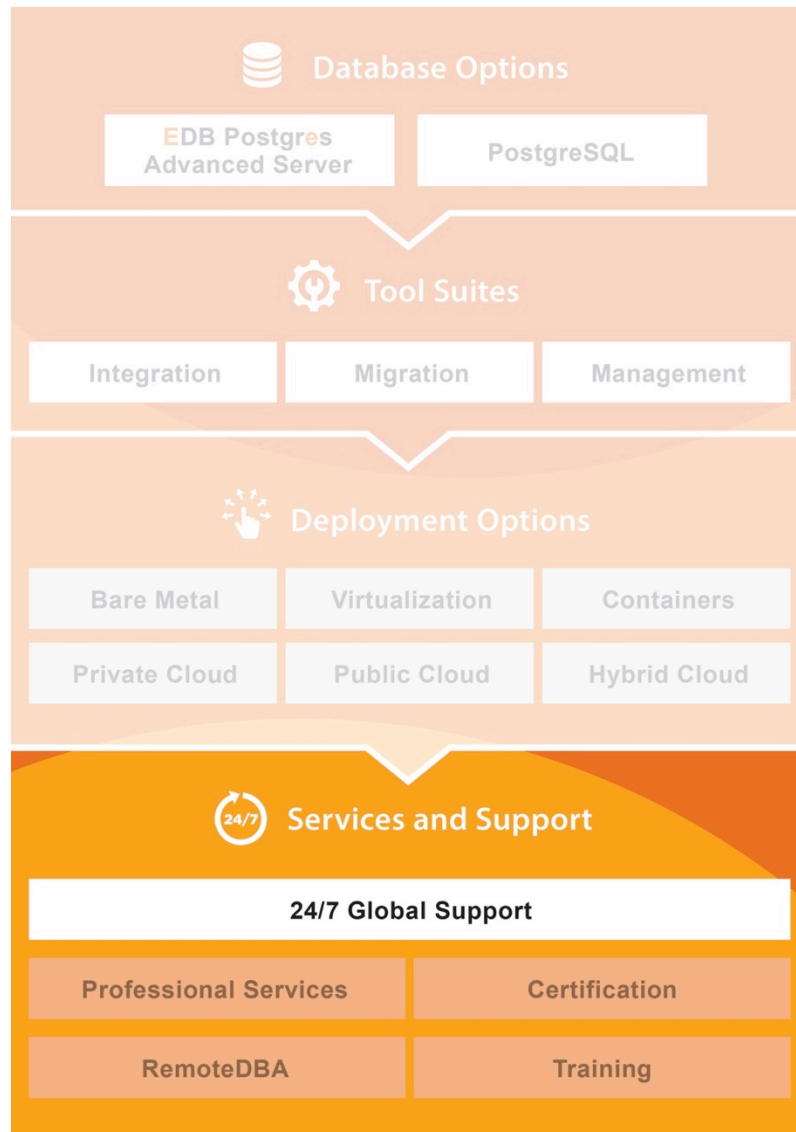

## 24/7 Global Support

- Production Support – 24 x 7
- Developer Support – 10 x 5

# EDB PostgreSQL & EDB Postgres Advanced Server

# EDB Postgres

## ADVANCED SERVER

- Continuously synchronized with PostgreSQL for a super-set of community PLUS enterprise features

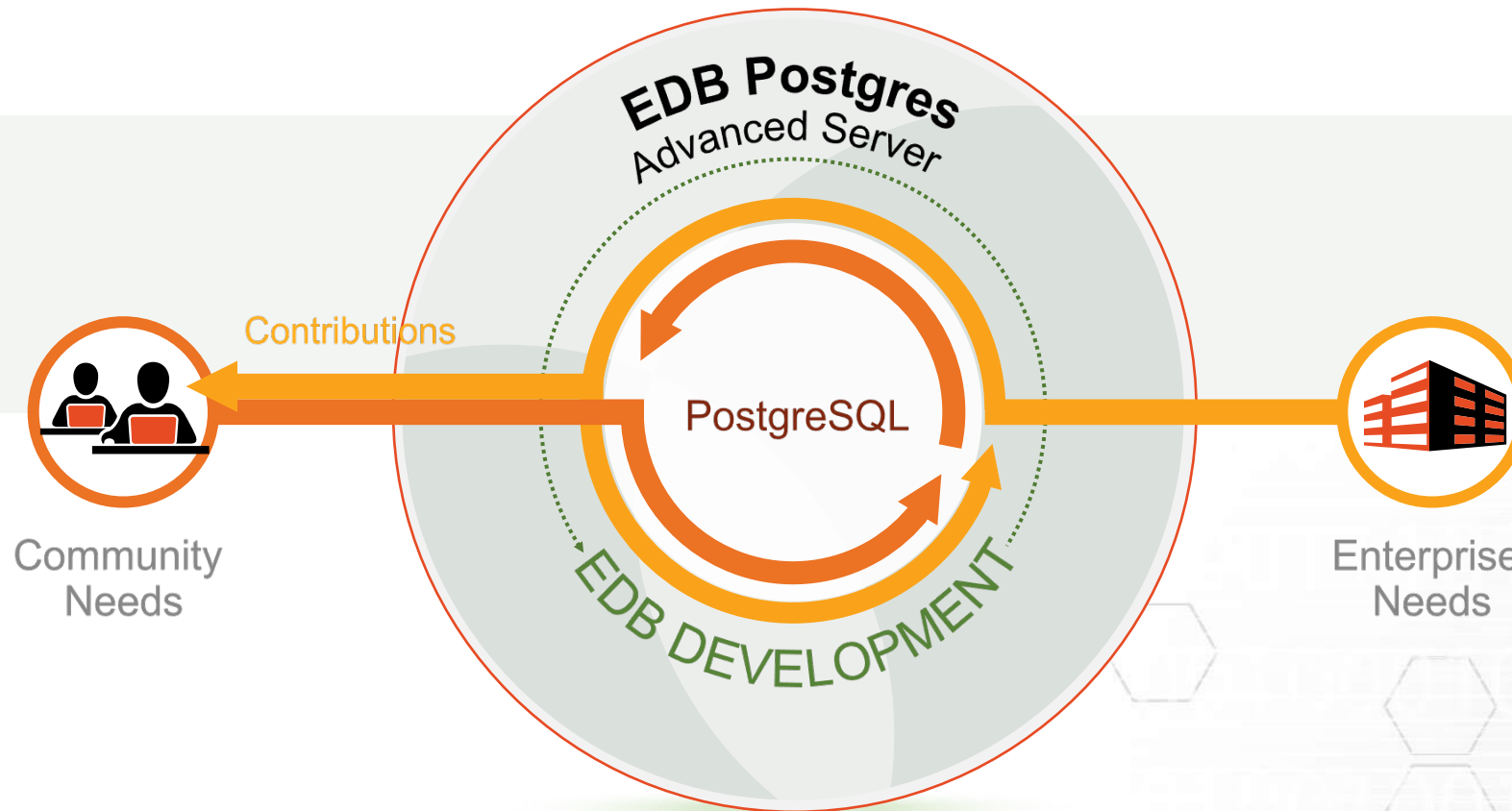

# EDB Postgres

ADVANCED SERVER

Security

Tools

Performance

Compatibility

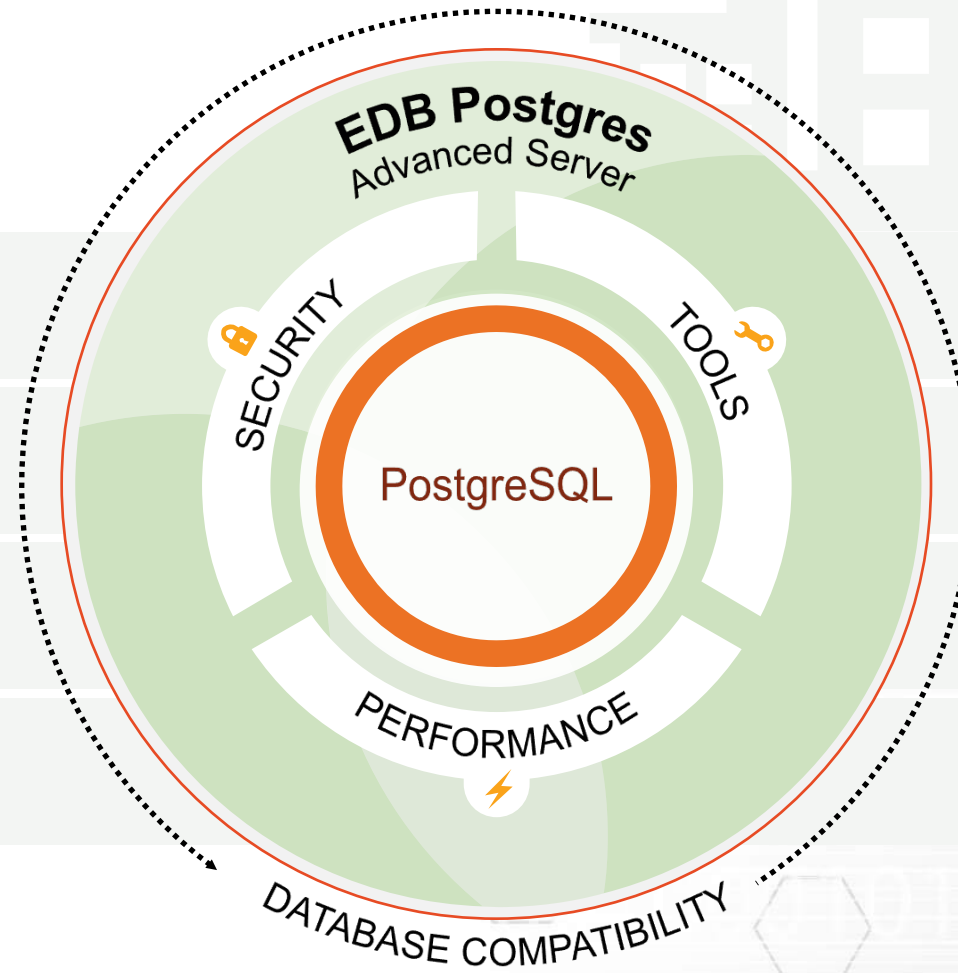

# Database Compatibility for Oracle®

# Database Compatibility for Oracle®

Compatible with:

*Your people*



Oracle  
Developers

*Your apps*



Oracle  
Applications

*Your business*



Lower Costs and  
Increased Agility

- Run applications written for Oracle virtually unchanged
- No need to retrain Oracle DBAs and developers
- Support for PL/SQL language and OCI interoperability
- Replication for easy sharing of data

*No disruption to your ongoing operations!*

# Case Studies



Become our showcase for Uniface®

# Discussion

- Questions?



THANK YOU

merci  
grazie  
spasiba  
kam ouen  
gratzias  
tak  
manana  
mahalo  
hvala  
cheers  
toda  
gracias  
welalin  
kitos  
grassie  
thank you  
danki

mahalo  
danki  
gracias  
thanks  
domo arrigato  
takki  
danke  
gratitude  
merci  
na gode  
mes  
dankon  
modupe  
talofa  
miigwetch  
kitos  
takk  
dziekuje